

INSERTO LISCIO CIECO TESTA LARGA
FLAT HEAD ROUND PLAIN BODY CLOSED

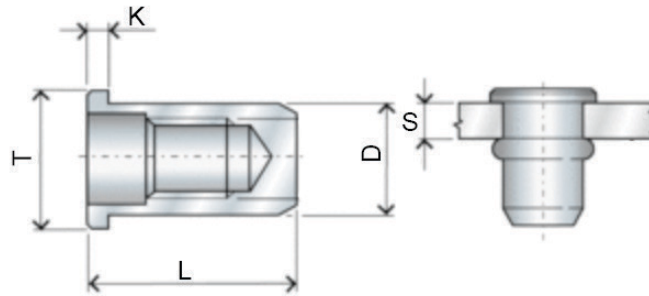

COD.	FIL	D	T	K	L	F	SPESS. LAMIERA
DGW60258 DGW60259	M3-C M3-L	4,9	8	0,8	9,5 10,5	5	0,2-1,8 1,8-3,0
DGW60260 DGW60261	M4-C M4-L	5,9	9	0,8	11 13	6	0,3-2,5 2,5-4,0
DGW60262 DGW60263	M5-C M5-L	6,9	10	1,2	13 15	7	0,5-3,0 3,0-5,0
DGW60264 DGW60265	M6-C M6-L	8,9	12	1,5	14,5 17,5	9	2,3-4,0 4,0-6,0
DGW60266 DGW60267	M8-C M8-L	10,9	15	1,5	17,5 20	11	0,8-3,5 3,5-6,0
DGW60270 DGW60271	M10-C M10-L	12,9	17	1,7	21 24	13	1,0-3,5 3,5-6,0

* Disponibile anche misura M12 F16
On request also size M12 F16

* Disponibile anche in INOX
On request also in stainless steel